

July 8, 2008

Dear PVA Alumnus or Alumna,

The Pioneer Valley Academy Alumni Association membership is a very diverse group. The one thing we share in common is youthful time spent on a country campus more than a quarter century ago.

We are hoping that the many different parts of our constituency will all feel welcome to join us at Camp Winnekeag in South Ashburnham, MA the weekend of October 17-19 for the PVA Reunion 2008. We will be honoring the Classes of 1968, 1973, 1978 and 1983 as they celebrate important milestones in their lives since graduating from our alma mater. However, since we only do this every four years, we want to see all of you there. We do not care if you are still an SDA in "good standing." We don't care if your hair is long, short, natural, dyed or gone. We don't care if you have put on a few or many pounds. We don't care if you are still with the mate of your youth, never wed, or enjoying middle age with someone new. We just want you to come as you are – dressed in the finest and laden with gold or "forever in blue jeans;" expertly coiffed with stylish make-up or clean faced and natural; clean shaved or bearded. We want to spend time with YOU remembering, but also sharing and celebrating the lives we have lived during the decades since we roamed our common campus.

Yes, there will be Vespers and a Sabbath Morning Worship Service, but if you would rather just enjoy the fall foliage and the beauty of the lake in the company of old friends, we won't be checking attendance and some of your company may surprise you.

Our Registration forms are finally ready. We have planned the menu and worked out the details for accommodations. We even have a great new hat to offer you. Camp Winnekeag offers space for approximately 180 people: mostly in bunk beds in four-bunk lodge rooms and 8/10-bunk cabins; or at a few RV and tent sites. These are inexpensive (all under \$30 per person per night). In this packet you will find the description of the various accommodations we have to offer at Winnekeag as well as our menu. For those seeking a little more comfort and an "off-campus" location, I have prepared a list of area hotels, motels, bed and breakfast inns and RV campgrounds. Most of the RV parks also have rental cabins available.

Hope to see you all in October.

Yours truly,

Dorothy

Dorothy Tissair Nesbitt '67
PVA Reunion 2008 Coordinator

Map To Camp

Camp Winnekeag

"The Camp That Cares"

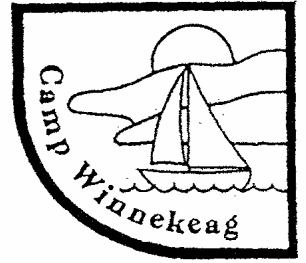

Map to Camp

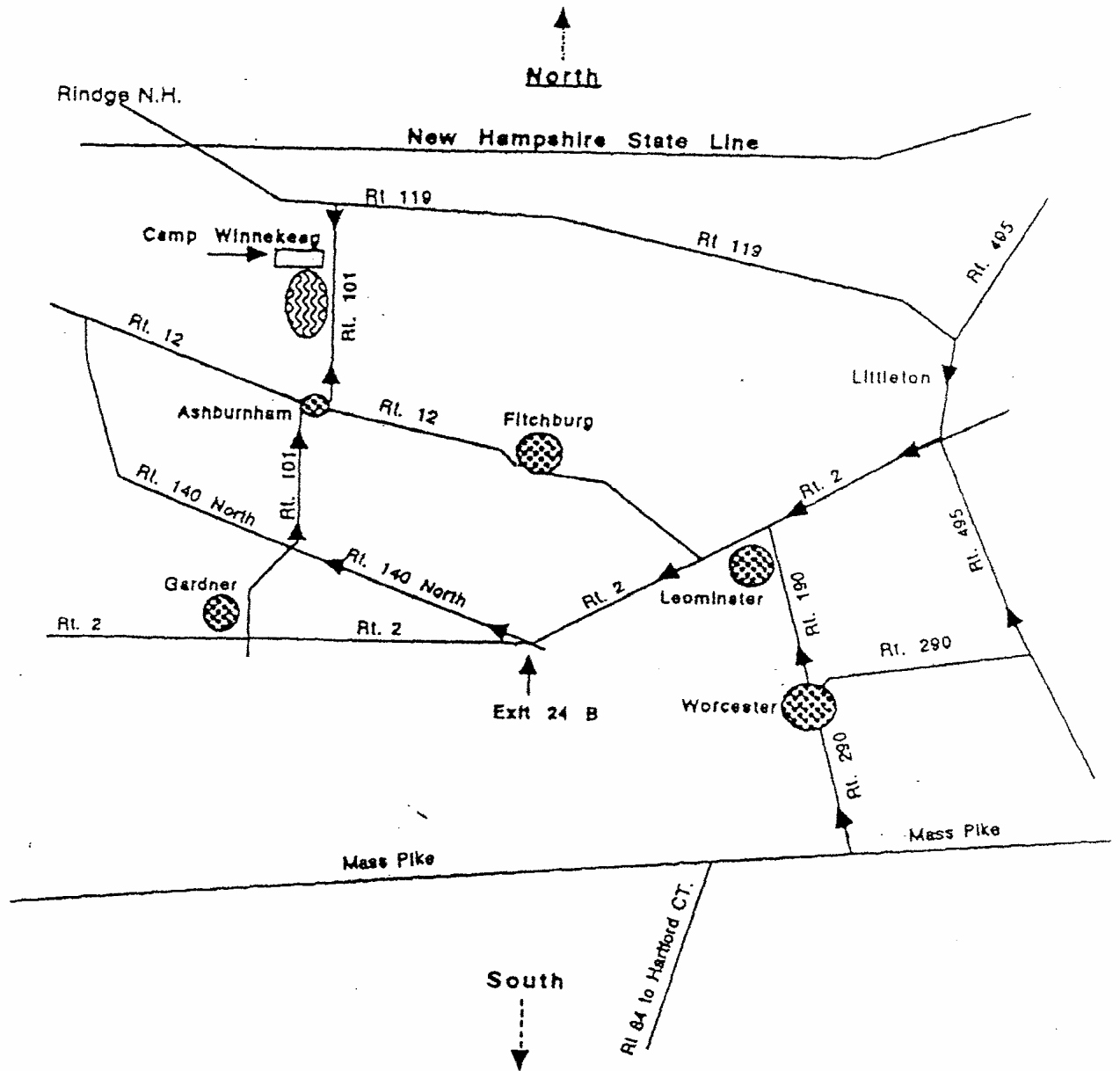

Pioneer Valley Academy
Reunion 2008
Camp Winnekeag
October 17-19

Weekend Menu

Friday, October 17

Pot Luck Supper Buffet
in
Pathfinder Lodge

Saturday, October 18

Boxed Continental Breakfast

Cinnamon Bun
Cold Cereal
Banana
Milk
Orange Juice
Hot Drink
\$6.75

Sabbath Dinner

Salad Bar
Vegetarian or Vegan Loaf
Mashed Potatoes with Home made Gravy
Corn, Broccoli Blend or Butternut Squash
Fresh Baked Dinner Rolls
Choice of Beverages
Pie with Ice Cream
\$7.40 Adult / \$ 6.75 Under 10

Saturday Supper

Pizza
Salad
Veggies and Dip
Fruit
Choice of Beverages
\$7.40 Adult / \$ 6.75 Under 10

Saturday, October 18

Showtime Saturday Night

Cupcakes
Cookies
Fruit
Nuts
Punch
Hot Beverages

Free with Pizza Supper

Sunday, October 19

Farewell Breakfast

Waffles with Fruit Topping and Whipped Cream
Tofu
Scrambled Eggs
Hash Browns
Cream of Wheat
Fruit
Choice of Beverages

\$7.40 Adult / \$ 6.75 Under 10

**Pioneer Valley Academy
Reunion 2008
Camp Winnekeag
October 17-19**

Rooms Available on Grounds

Headquarters Building

Guest Room #1 – Bedroom with one Full size bed and linen provided. Share adjoining bathroom with Guest Room #3. **\$50.50 per night double occupancy.** Additional refundable Cleaning Deposit \$15 required.

Guest Room #2 – Bedroom with one Queen size bed and linen provided. Share adjoining bathroom with Guest Room #4. **\$50.50 per night double occupancy.** Additional refundable Cleaning Deposit \$15 required.

Guest Room #3 – Bedroom with two Twin Beds and linen provided. Share adjoining bathroom with Guest room #1. **\$50.50 per night double occupancy.** Additional refundable Cleaning Deposit \$15 required.

Guest Room #4 – Bedroom with one Queen sized bed and one Fold-down Twin sized bed and linen provided. Share adjoining bathroom with Guest Room #2. **\$50.50 per night double, \$75.75 triple occupancy.** Additional refundable Cleaning Deposit \$15 required.

Preference will be given to parties booking two nights.

Pathfinder Lodge

Rooms #1 & #2 – Room with one Double sized bed and two bunks (upper and lower) linen available at extra cost. Share hall bathrooms with Rooms 3-7. **Family (2-4 persons) occupancy \$48.70 per night.** Linen charge is \$6.40 per person – advanced request required. Additional refundable Cleaning Deposit \$15 required.

Rooms #3-7 – Room with two upper and two lower bunks, linen available for extra cost. Share hall bathrooms with Rooms #1 and #2. **Immediate Family Group \$48.70 per night. Singles sharing quad occupancy \$15.85 per night each.** Linen charge is \$6.40 per person – advanced request required. Additional refundable per room Cleaning Deposit \$15 required.

Rooms #8-14 – Room with two upper and two lower bunks, linen available for extra cost. Share hall bathrooms with Rooms #8 and #14. **Immediate Family Group \$48.70 per night. Singles sharing quad occupancy \$15.85 per night each.** Linen charge is \$6.40 per person – advanced request required. Additional refundable per room Cleaning Deposit \$15 required.

Preference will be given to Family groups especially those booking two nights in Pathfinder Lodge. Individuals booking less than four bunks together will be accommodated in Junior/Teen Camp Cabins.

Junior/Teen Camp Cabins

Boy's Village Cabins (6) – Eight Bunks (four upper, four lower) per cabin with four bunk (two upper, two lower) counselor's room between two cabins. No linen available. Use Main Bath House. **\$13.10 per bunk per night.** A refundable cleaning deposit of \$5 will be required.

Girl's Village Cabins (6) – Nine Beds (four upper, four lower, one single) per cabin with counselor's room (two single beds) between two cabins. No linen available. Use Main Bath House. **\$13.10 per bunk per night.** A refundable cleaning deposit of \$5 per bunk will be required.

Single gender groups are encouraged to book bunks in Cabins we reserve the right to fill empty bunks not booked by any given group. Cabins still unoccupied on September 15 will be offered to Family Groups at a reduced rate.

Tent Sites (12) – For those accustomed to fall camping we offer tent sites for up to six-persons per tent. Massachusetts law prohibits gas or propane heaters, stoves, or lanterns and all candles from inside tents. Use Main Bathhouse. Campers should plan on eating meals with the Alumni Group. **\$20.15 per tent per night.** A refundable \$15 per site cleaning deposit will be required.

RV Sites (5) – Sites with water and electric hook-ups. **\$30.15 per site per night.** A refundable \$15 per site cleaning deposit will be required.

Cleaning deposits, in the form of cash or personal check, will be collected separately upon check-in and refunded at check-out inspection. We are offering extremely affordable accommodations at the rate charged to us by the camp. The Alumni Association will be charged \$20/hr for cleaning of any areas not deemed cleaned. Your help in keeping the buildings and grounds clean is greatly appreciated.

Commuter Fee – **Persons not staying overnight** will be required to pay a **\$4 per person commuter fee each day** (Friday, Saturday and Sunday) to attend the Reunion, so consider staying on the grounds.

Camp Winnekeag

257 Ashby Rd.
Ashburnham, Mass.

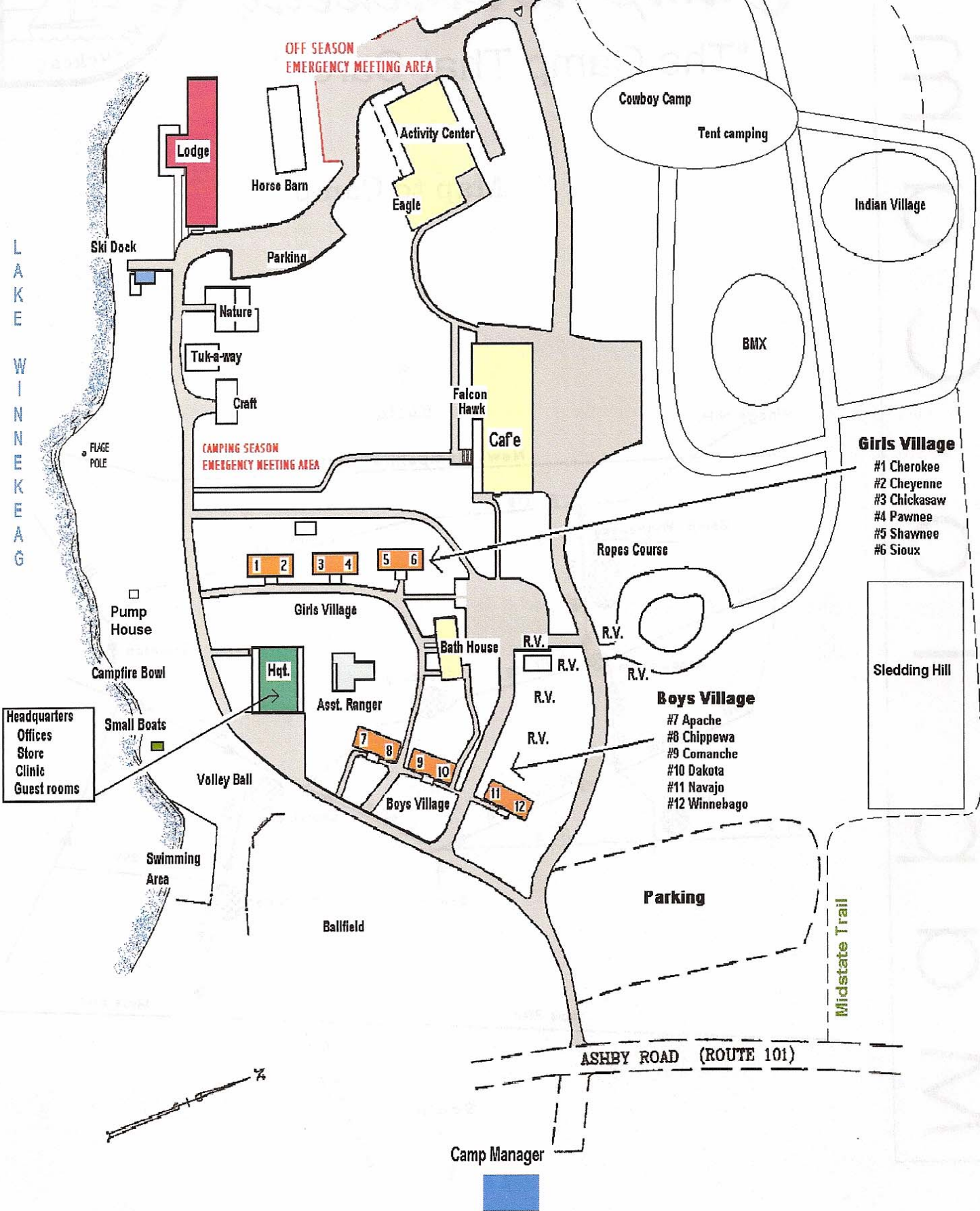

Girls Village

- #1 Cherokee
- #2 Cheyenne
- #3 Chickasaw
- #4 Pawnee
- #5 Shawnee
- #6 Sioux

Boys Village

- #7 Apache
- #8 Chippewa
- #9 Comanche
- #10 Dakota
- #11 Navajo
- #12 Winnebago

- Headquarters
- Offices
- Store
- Clinic
- Guest rooms

ASHBY ROAD (ROUTE 101)



Hotels/Motels near Camp Winnekeag

Colonial Hotel

625 Betty Spring Road
Gardner, MA 01440
978-630-2500

Super 8 Gardner MA

22 North Pearson Blvd
Gardner, MA 01440
800-804-6835

Best Western Royal Plaza Hotel

150 Royal Plaza Dr
Fitchburg, MA 01420
800-804-6835

Super 8 Leominster Fitchburg

482 N Main St
Leominster, MA 01453
800-804-6835

Four Points by Sheraton Leominster

99 Erdman Way
Leominster, MA 01453
Phone: 978-534-9000

Super 8 Motel - Greenfield

21 Colrain Rd
P.o. Box 529
Greenfield, MA 01301
800-804-6835

Hampton Inn Suites Greenfield

184 Shelburne Rd
Greenfield, MA 01301
Tel: 413-773-0057
Fax: 413-223-1300

Search your favorite travel website
for Worcester or Lowell, MA or
Nashua or Keene, NH for more.

Bed & Breakfast - Inns

The Maguire House

30 Cobb Rd.
Ashburnham, MA 01430
Phone: 978-827-5053
Fax: 978-827-9928
E-mail: maguirehouse@earthlink.net

Woodbound Inn

247 Woodbound Road
Rindge NH 03461
USA
Phone: 603-532-8341
Fax: 603-532-8341 ext 43
Toll-free: 1-800-688-7770
E-mail: reservations@woodbound.com

The Inn at Jaffrey Center

379 Main Street
PO Box 484
Jaffrey Center, NH 03452
Phone: 603-532-7800
Fax: 603-532-7900
Toll-free: 877-510-7019
Email: theinn3452@comcast.net

Benjamin Prescott Inn

Route 124 East
Jaffrey NH 03452
USA
Phone: 603-532-6637
Fax: 603-532-1142
Toll-free: 1-888-950-6637
Email: innkeeper@benjaminprescottinn.com

Please see www.BedandBreakfast.com
for many more in the Central MA,
Monadnock NH, or Merrimack Valley
Regions of both states.

RV Campgrounds

Most with Rental Cabins and Tent sites

Howe's Camping

133 Sherbert Rd
Ashburnham, MA 01430
Tel: 978-827-4558

Woodmore Campground

21 Woodmore Drive
Rindge, NH 03461
Tel: 603-899-3362
Email: info@woodmorecampground.com

Peaceful Pines Family Campground

2 Peaceful Pines Street
Templeton, MA 01440
Tel: 978-939-5004
Email: info@peacefulpinescampground.net

Lamb City Campground

85 Royalston Road
Phillipston, MA 01331
Tel: 978-249-2049
Toll Free: 1-800-292-lamb (5262)
Email: Lambcity@Comcast.net

Coldbrook Resort and Campground

860 Old Coldbrook Road
Barre, MA 01005
Tel: 978-355-2090
Email: office@coldbrookcountry.com

Boston Minuteman Campground

264 Ayer Road
Box 2122
Littleton, MA 01460-3122
Tel: 978-772-0042
Toll Free: 877-677-0042
Email: Info@MinutemanCampground.com

Field and Stream RV Park

7 Dupaw Gould Rd
Brookline, NH 03033-2213
Tel: 603-673-4677

Ashuelot River Campground

152 Pine Street
Swanzy, NH 03446
Phone & Fax: 603-357-5777
Toll-Free: 1 888 355-2267
Email:
camping@ashuelotriverscampground.com

Swanzy Lake Camping Area

88 East Shore Road
Swanzy, NH 03446
Tel: 603-352-9880
Email: info@swanzylake.com



Get Your Official Pioneer Valley Academy Logo Hat Here!

The hat will cost you \$15 if you pre-order and pre-pay for your hat with your reunion registration. You'll be able to pick it up on Alumni Weekend !!!

OR You may order on Alumni Weekend, but you will have to pay an extra \$5 for shipping and handling. We'd prefer not to have to ship, so please order with your registration if possible.

OR For those of you who can't attend the reunion. You may send your order to us with your payment of \$20 and we'll mail your hat to you.

(We need orders for 100 prepaid hats in order to have them ready for the reunion. This number can include prepaid orders to be shipped. So please place your order today!)

Pioneer Valley Academy Alumni Association
Reunion 2008
Camp Winnekeag
October 17-19, 2008

Registration Form

Name _____ Class _____

Address _____

Telephone _____ Email _____

Meals: Preference: Vegetarian _____ or Vegan _____ (Check One)

	How Many?	
Boxed Continental Breakfasts @ \$6.75 each		\$ _____
Sabbath Dinners @ \$7.40 Adult / \$6.75 Under 10	Adults: Under 10:	\$ _____
Saturday Pizza Suppers @ \$7.40 / \$ 6.75 Under 10	Adults: Under 10:	\$ _____
Showtime Saturday Night Dessert Bar		Free with Saturday Supper
Sunday Hot Breakfast @ \$7.40 / \$ 6.75 Under 10	Adults: Under 10:	\$ _____
	Meals Total:	\$ _____

***Commuter/Parking Fees:**

Friday Night	Driver and Passengers _____	X \$4 each	\$ _____
Saturday	Driver and Passengers _____	X \$4 each	\$ _____
Sunday Clean-up	Driver and Passengers _____	Free	\$ <u>FREE</u>
		Commuter Total:	\$ _____

***Not applicable to persons booking Overnight Accommodations.**

Overnight Accommodations: Please indicate preference

Headquarters Room @ \$50.50 per night	Fri. Sat. Both	\$ _____	\$15 refundable cleaning deposit due at Check-in.
Family Lodge Room @ \$48.70 per night (2-4 family members)	Fri. Sat. Both	\$ _____	\$15 refundable cleaning deposit due at Check-in.
Lodge Bunk @ \$15.85 per night	Fri. Sat. Both	\$ _____	\$5 refundable cleaning deposit due at Check-in.
Linen for Lodge Beds @ \$6.40 per bed	Fri. Sat. Both	\$ _____	
Cabin Bunk @ \$13.10 per night	Fri. Sat. Both	\$ _____	\$5 refundable cleaning deposit due at Check-in.
Tent Site @ \$20.15 per night (Up to 6 persons per site)	Fri. Sat. Both	\$ _____	\$15 refundable cleaning deposit due at Check-in.
RV Sites @ \$30.15 per night (As per rig limits)	Fri. Sat. Both	\$ _____	\$15 refundable cleaning deposit due at Check-in.
Accommodations Total:		\$ _____	

<p>Registration Forms May Be Submitted By:</p> <p>Email to pvainfomanager@yahoo.com,</p> <p>Fax to 1-860-395-1583 or</p> <p>US Post to: Pioneer Valley Academy Alumni 7 Johnnel Street Paxton, MA 01612</p> <p>Make Checks Payable to: Pioneer Valley Academy Alumni and mail to address above.</p>	Meals Total:	\$ _____
	Commuter/Parking Total:	\$ _____
	Accommodations Total:	\$ _____
	Pre-Order Hats - ____ @ \$15 each:	\$ _____
	Free Will Offering:	\$ _____
	Total Due:	\$ _____

**Please register in advance to assure Meals and Overnight Accommodations.
 Advanced Registration closes October 2, 2008.**

Official Pioneer Valley Academy Logo Hat Order Form

There is a place for you to order your hat(s) on the Reunion Registration form. Only use this form if you are not attending the reunion, but would like to order one or more hats. Thank You!

Name: _____

Address: _____

Email: _____

Phone: _____

I would like to order _____ hat(s). Enclosed is my check or money order for \$20 (includes \$5 S&H) for each hat ordered.

Mail to:

Alex Bezerra

208-C Hall St.

Leominster, MA. 01453-2777

debal1@juno.com